



CAPITAL

(H-SERIES)

HOTEL MODE



User Instructions

TABLE OF CONTENTS

1. About Capital Safe.....	1
1.1 Important Instructions.....	2
1.2 Accessories Description.....	2
2. Know Your Product.....	3
3. Operating the Safe.....	3
4. Emergency Override Key.....	4
5. Mounting.....	5
6. Replacing The Batteries.....	6
7. Information On E-waste Handling And Management.....	7

CAPITAL SAFE

I am small enough to fit anywhere,
big enough to protect your valuables.



Capital

Capital is a compact, secure and affordable option to safeguard your precious possessions.

Ideal for



Daily use
valuables



Electronic Locking
System



Low Battery
Indicator

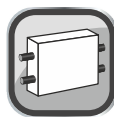

Two Solid Steel
Shooting Bolts



Mechanical
Override



External Power
Source For Emergency Use

- Interior carpet
- Digital locking mechanism

- Secret password
- Can be grouted / Anchored

	8L	15L	25L
Dimensions in cm (HxWxD)	20 x 31 x 20	25 x 35 x 25	20 x 42 x 37
Net weight (Kg.)	4.8	6.6	10
Volume (ltr.)	8	15	25

1.1 IMPORTANT INSTRUCTIONS

Please keep this manual and override keys in a safe place (**NOT INSIDE THE SAFE**)

DO NOT use any liquid while cleaning the keypad, you could use a damp cloth if required
Make sure the safe is anchored properly as it can fall and hurt people and property.

DO NOT place any liquid on top of the safe, a spill on the keypad may render the safe inoperable.

DO NOT overstuff the safe or you can damage the motor mechanism or the contents.

DO NOT place the safe in direct sunlight in case of Biometric.

For security purposes, you should change the factory default code i.e. Personal Code AND Master Code as soon as possible. Godrej Security Solution shall not be responsible for any theft caused by such negligence.

DO NOT open the back cover or try to repair the safe yourself. In case of any problem contact GSS call center at **1800 20 999 55** or write to us at secure@godrej.com

1.2 ACCESSORIES DESCRIPTION

Items (accessories)	Items (accessories)	Qty
Safe	Standard configuration	1 set
1.5V AA alkaline battery	Standard configuration	4 pcs
User Manual	Standard configuration	1 copy
Fastening screws	Standard configuration	4 pcs
Protection pad	Standard configuration	1 Sheet
Mechanical Override Key	Standard configuration	2 Keys

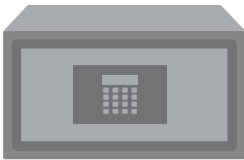

Safe



Warranty Card

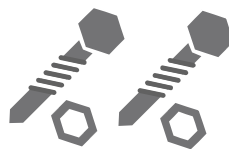

Anchoring Bolts

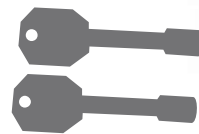

Override Keys



1.5 V Alkaline Battery

2. KNOW YOUR PRODUCT

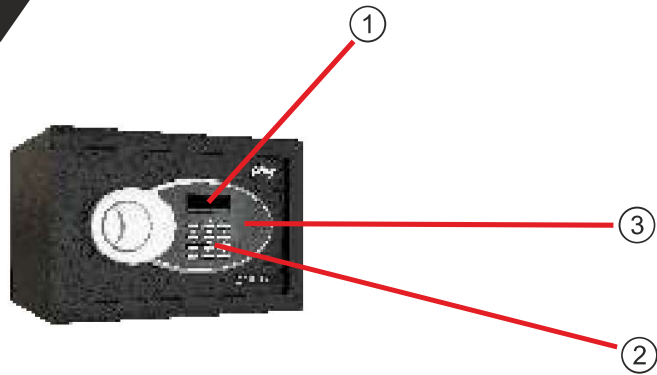

Front view of the safe

1. Status indicators 2. Operation button key pad 3. Mechanical emergency keyhole

Note: The reset button for the safe has been provided next to the battery holder

3. OPERATING THE SAFE

How To Open The Safe With User Code

- Input **4-8** digit user code and press (**#**). If the user code is correct, you will hear 2 short beeps and the green indicator (**OK**) light will be on. Rotate the knob clockwise to open the safe.
- If the user code is wrong, there will be 3 short beeps and the yellow indicator light will flash 3 times.
- The default user code is **1234**.

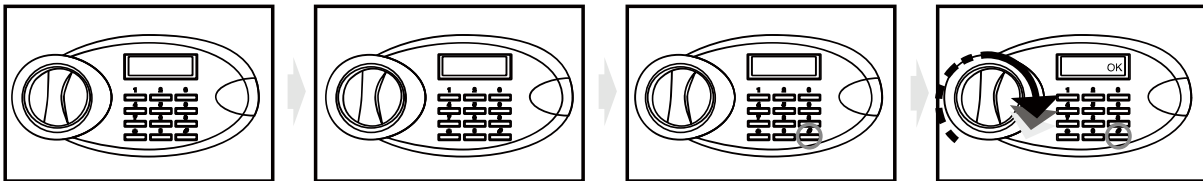

How To Open The Safe With Master Code

- Input 6 digit master code and press (**#**). If the master code is correct, you will hear 2 short beeps and the green indicator (**OK**) light will be on. Rotate the knob clockwise to open the safe.
- If the master code is wrong, there will be 3 short beeps and the yellow indicator light will flash 3 times.
- The default master code is **800000**.

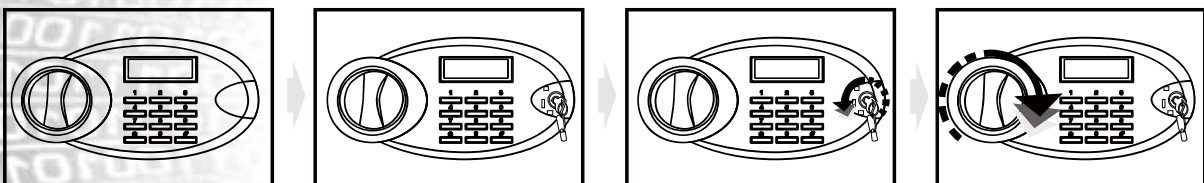

WARNING:

If wrong code is entered 3 times continuously, the safe will be locked and alarm will sound for 20 seconds, after 20 seconds you can enter personal/ master code. If again wrong code is entered 3 times continuously, the safe will be locked and the alarm will sound for 5 minutes. During lockout, the safe goes in auto freeze mode.

How To Close The Safe

Input **4-8** digit new code. You will hear 2 short beeps. Rotate the knob anti-clockwise to close the safe.

How To Set The User Code

When the safe is in open condition, input new **4-8** digit user code. You will hear 2 short beeps. Rotate the knob anti-clockwise to close the safe.

How To Set The Master Code

The master code can be set in either open condition or closed condition, Input (*) 2 times, you will hear 2 short beeps, input the original master code and press (#), you will hear 3 short beeps while a yellow light is also on, then input the new master code (6 digits only) and press (#), you will hear 2 short beeps which means the setting is successful.

However, we recommend that while setting any new password, safe is kept in opened condition. Once password is changed, test it in open condition and if working properly, then close it.

How To Reset The Safe To Default Mode

When the safe is in open condition, press and hold the reset button until you hear 2 short beeps which means the resetting is successful.

Automatic Locking

3 continuous incorrect inputs of the code will put the keypad on auto freeze mode for 20 seconds.

Another 3 incorrect inputs of the code will put the keypad on auto freeze mode for 5 minutes.

4. EMERGENCY OVERRIDE KEY

When you first get the safe or in emergency like batteries running out, codes unknowns etc. you can open the safe using the following method:

1. Remove the emergency cover.
2. Using one of the emergency override keys, insert into the cylinder and turn anti-clockwise and turn the knob clockwise to open the door.
3. While the door is open, follow the instructions to set your personal code.

WARNING:

Keep the override keys in a safe place other than inside this safe. These keys are to be used in emergencies.

5. MOUNTING

Mounting Through The Bottom Of The Safe:

- Check the floor for what type it is (wood, tile, concrete).
- Get the appropriate anchors for the type of floor.
- Check location on floor for concealed wires or pipes.
- Mark the floor to drill for your anchor.
- Drill the appropriate size hole for the anchors you have.
- Mount the safe, making sure it is secure.
- For mounting to the top of a cabinet you may want to use carriage bolts through the top of the cabinet.
- **DO NOT** mount to a shelf in a cabinet or closet without anchoring to wall behind the safe.

Mounting Through The Back Of The Safe:

- Check the wall or cabinet for structural Soundness.
- For safety, have someone help to hold the safe during mounting.
- Check location for concealed wires or pipes.
- Mark the surface to drill holes for the anchors you will be using.
- Drill the appropriate size holes for the anchors you are using.
- Having someone hold the unit, anchor the safe to the wall.

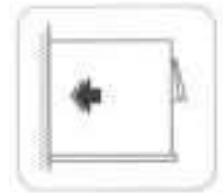

Mounting Tips:

- The safe may be mounted to a wall or the inside of a cabinet or on the floor.
- When mounting to a wall or cabinet, be sure of the load bearing capacity so as to hold the weight of the safe and the contents.
(Failure to do so could result in the safe falling and damaging property and people)

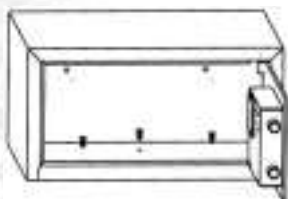

Fig I: Fix through baseboard

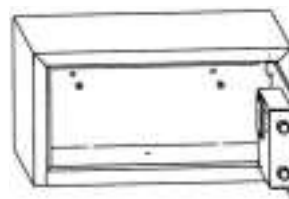

Fig II: Fix through backboard

6. REPLACING THE BATTERIES

1. Open the Safe using your personal code. If the batteries are dead, use the Emergency Override key.
2. Remove the battery cover on the back panel by sliding it towards the right.
3. Remove all four used batteries.
4. Replace the batteries with four 1.5V AA size alkaline batteries.
5. Secure the battery cover by sliding it towards the left.
6. Dispose the used batteries in an environment friendly way.
7. Keeping the door open, test the safe to make sure it works.

Note: A micro External Power Supply jack has been provided on the lock unit to Power ON the lock externally incase the battery drains out completely.

7. INFORMATION ON E-WASTE HANDLING AND MANAGEMENT

Dear Customer,

The Ministry of Environment and Forest and Climate Change have published The E-waste (Management) Rules 2022, which came into effect from 1st day of April 2023.

- E-waste means electrical and electronic equipment, including solar photo-voltaic modules or panels or cells, whole or in part discarded as waste, as well as rejects from manufacturing, refurbishment and repair process.
- These rules shall apply to every manufacturer, producer, refurbisher, dismantler and recycler involved in manufacture, sale, transfer, purchase, refurbishing, dismantling, recycling and processing of e-waste or electrical or electronic equipment listed in Schedule-I of the rules including their components, consumables, parts and spares which make the product operational but shall not apply to
 - (a) Waste batteries as covered under the Battery Waste Management Rules 2022
 - (b) Packaging plastics as covered under the Plastic Waste Management Rules 2016
 - (c) Micro enterprises as defined in the Micro, Small and Medium Enterprises Development Act, 2006
 - (d) Radio-active wastes as covered under the provisions of the Atomic Energy Act, 1962 and rules made thereunder.
- Under these rules, specific roles and responsibilities are defined for manufactures, producers, bulk consumers, refurbishers and recyclers. Under Extended Producer Responsibility any producer of electrical or electronic equipment as given in Schedule-I for meeting recycling targets as per Schedule-III and Schedule -IV, only through registered recyclers of e waste to ensure environmentally sound management of such waste.
- E-waste is to be managed in an environmentally sound manner which means, taking steps to ensure that health and environment are protected from adverse effects of hazardous substance contained in such wastes.
- Rule 6 of the E-waste (Management) Rules 2022 interalia states that the producer of electrical and electronic equipment listed in Schedule -I shall be responsible for creating awareness through, media, publications, advertisements, posters or by any other means of communication.
- Rule 16 of the E- Waste (Management) Rules 2022 states reduction in the use of hazardous substances in the manufacture of electrical and electronic equipment and their components or consumables or parts or spares and every producer shall comply with the requirements under the rule.
- All consumers of electrical and electronic equipment irrespective of their status as bulk consumers or not, shall ensure that e-waste generated by them is channelized through registered recyclers or is returned to the pickup/take back services provided by the producers and recyclers. **Please refer to our website <https://www.godrej.com/godrej-security-solutions#GreenThink> under the 'Green Think' section of Godrej Security Solutions Division Page for more details on registered recyclers and collection centers/pick up points of the company.**
- All our products intended to be recycled under the category of e-waste (as defined above) carry a label or stamp of the WEEE symbol (A wheelie bin with a cross), which states that it falls under the hazardous waste category and is not to be disposed of along with normal garbage.



We seek your support in ensuring environmentally sound management of e-waste and aid us in sustaining our earth's natural resources and maintaining the earth's green cover intact for the benefit of our future generations.

RECORD OF PURCHASE

Please fill your details below for future reference.

Date of purchase: _____

Product model: _____

Name & address of Distributor/Dealer: _____

Distributor phone number: _____

FOR SAFETY, PLEASE READ THIS MANUAL PRIOR TO USE.



Godrej & Boyce Mfg. Co. Ltd., Godrej Security Solutions
Regd. Office: Plant No. 17, Pirojshanagar,
Vikhroli, Mumbai - 400079

 **Toll Free:** 1800 209 9955 (**Sales & Service**)

 **Whatsapp Support:** +91 9321665511 (**Service**)

 **Visit:** www.godrejsecure.com

 **Email:** secure@godrej.com (**Sales**), secare@godrej.com (**Service**)

Follow us:  www.facebook.com/GodrejSecure

 www.twitter.com/godrejsecure

An ISO 9001:2015, ISO 14001:2015, ISO 45001:2018

Products Marketed and Serviced by Godrej and Boyce Mfg. Co. Ltd.